

DIN Gate Valve
General Valve



Product structural features

Gate valve seal acc. to DIN is applicable to the cutting and connection of pipelines medium that are used in various industries such as petroleum, chemical industry, pharmacy, chemical fertilizer, electric power industry, etc under nominal pressure of PN1.6~16MPa and working temperature within industries -110~600°C

Main structural features

1. This product has logical structure, reliable seal, excellent performance and nice design.
2. The seal surface is build-up welding with Wc-Co hard alloy, which is attrition-resistant, corrosion-resistant, has good friction resistant and long life.
3. The stem quenched and tempered, and its surface is treated by nitrating treatment, thus it has good corrosion resistant and friction resistant.
4. It has double seal capability, which is more reliable.
5. The part material, flange and butt weld end dimension may be selected according to current operating condition and users' requirement, so that meeting the requirements of various engineering.

Technical specification

Structural Formation: BB-BG-OS & Y
Driving Manner: Hand-Operated
Driving Manner: Electric-Actuated
Design Standard: DIN3352
Face to Face: DIN3202
Flange Ends: DIN2543-2547
Test & Inspection: DIN3230

Notes: The size of serial, valve connecting flange can be design according to customers' requirement.

Products performance specification

Nominal Pressure (MPa)	Shell Test (MPa)	Sealing Test (MPa)	Suitable Temp (°C)	Suitable Medium
1.6	2.4	1.76	-110~600°C	Water Oil & Gas
2.5	3.75	2.75		
4.0	6.0	4.4		
6.4	9.6	7.04		

Technical specification

- Structural Formation: BB-BG-OS & Y
- Driving Manner: Hand-Operated
- Driving Manner: Electric-Actuated
- Design Standard: DIN3352
- Face to Face: DIN3202
- Flange Ends: DIN2543-2547
- Test & Inspection: DIN3230

Notes: The size of serial, valve connecting flange can be design according to customers' requirement.

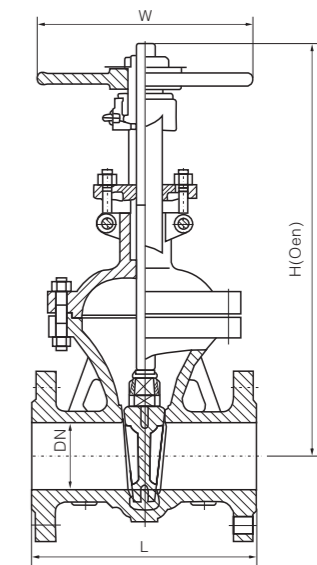

Main part material of Cast steel

Part	Material	Option 1	Option 2	Option 3	Option 4
Body	GS-C25				
Wedge Disc	GS-C25	1.4308	1.4408		
Stem	13Cr	1.4308	1.4408		
Wedge Disc Sealing Face	13Cr	13Cr	STL	1.4308	STL
Seat Ring Sealing Face	13Cr	STL	STL	1.4308	STL

Main part material of Stainless steel

Part	Material	Option 1	Option 2	Option 3	Option 4	Option 5	Option 6	Option 7	Option 8	Option 9	Option 10	
Body	1.4308	1.4408	1.4306	1.4301								
Wedge Disc	1.4308	1.4408	1.4306	1.4301								
Stem	F304	1.4408	1.4306	1.4301								
Wedge Disc Sealing Face	1.4308	1.4308	STL	1.4408	1.4408	STL	1.4306	1.4306	STL	1.4301	1.4301	STL
Seat Ring Sealing Face	1.4308	STL	STL	1.4408	STL	STL	1.4306	STL	STL	1.4301	STL	STL

DIN Gate Valve

GENERAL VALVE

Size main dimensions of Gate Valve

Pressure (MPa)		PN1.6MPa													
Size	mm	50	65	80	100	125	150	200	250	300	350	400	450	500	600
L		250	270	280	300	325	350	400	450	500	550	600	650	700	800
H		417	452	530	607	720	790	885	1014	1190	1350	1460	1630	1800	2200
W		200	280	280	300	350	350	400	450	500	600	600	650	700	800
Weight(kg)		16	25	30	55	75	98	150	245	353	490	750	985	1063	1390
Pressure (MPa)		PN2.5MPa													
Size	mm	50	65	80	100	125	150	200	250	300	350	400	450	500	600
L		250	270	280	300	325	350	400	450	500	550	600	650	700	800
H		417	452	530	607	720	790	885	1014	1190	1350	1460	1630	1800	2200
W		200	280	280	300	350	350	400	450	500	600	600	650	700	800
Weight(kg)		16	31	43	58	82	103	180	265	385	547	835	1050	1130	1500
Pressure (MPa)		PN4.0MPa													
Size	mm	50	65	80	100	125	150	200	250	300	350	400	450	500	600
L		250	290	310	350	400	450	550	650	750	850	950	1050	1150	1350
H		404	456	604	607	720	780	875	1260	1480	1605	1788	1956	2168	2601
W		200	280	300	350	350	400	450	500	500	600	650	700	700	800
Weight(kg)		18	32	47	60	95	130	220	290	490	760	900	1250	1450	1700
Pressure (MPa)		PN6.4MPa													
Size	mm	50	65	80	100	125	150	200	250	300	350	400	450	500	600
L		250	290	310	350	400	450	550	650	750	850	950	1050	1150	1350
H		404	456	604	607	720	780	875	1260	1480	1605	1788	1956	2168	2601
W		200	280	300	350	350	400	450	500	500	600	650	700	700	800
Weight(kg)		20	35	52	66	103	140	230	300	510	780	940	1300	1600	1850

DIN Globe Valve

GENERAL VALVE

DIN Globe Valve General Valve



Product structural features

Globe valve seal acc. to DIN is applicable to the cutting and connection of pipelines medium that are used in various industries such as petroleum, chemical industry, pharmacy, chemical fertilizer, electric power industry etc under nominal pressure of PN1.6~16MPa and working temperature within -110~600°C

Main structural features

1. This product has logical structure, reliable seal, excellent performance and nice design.
2. The seal surface is build-up welding with Co hard alloy, which is attrition-resistant, corrosion-resistant, has good friction resistant and long life.
3. The stem quenched and tempered, and its surface is treated by nitrating treatment, thus it has good corrosion resistant and friction resistant.
4. The part material, flange and butt weld end dimension may be selected according to current operating condition and users' requirement, so that meeting the requirements of various engineering.

Technical specification

Structural Formation: BB-BG-OS & Y
 Driving Manner: Hand-Operated
 Driving Manner: Electric-Actuated
 Design Standard: DIN3356
 Face to Face: DIN3202
 Flange Ends: DIN2543-2545
 Test & Inspection: DIN3230

Notes: The size of serial, valve connecting flange can be design according to customers' requirement

Products performance specification

Nominal Pressure (MPa)	Shell Test (MPa)	Sealing Test (MPa)	Suitable Temp (°C)	Suitable Medium
1.6	2.4	1.76	-110~600°C	Water Oil & Gas
2.5	3.75	2.75		
4.0	6.0	4.4		
6.4	9.6	7.04		

DIN Globe Valve

GENERAL VALVE

Technical specification

- Structural Formation: BB-BG-OS & Y
- Driving Manner: Hand-Operated
- Driving Manner: Electric-Actuated
- Design Standard: DIN3356
- Face to Face: DIN3202
- Flange Ends: DIN2543-2545
- Test & Inspection: DIN3230

○ Notes: The size of serial, valve connecting flange can be design according to customers' requirement.

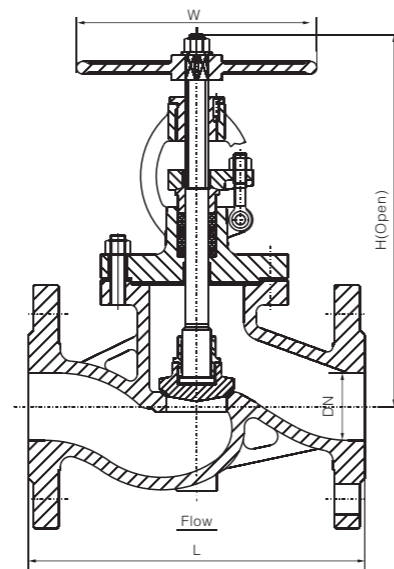

Main part material of Cast steel

Body	GS-C25											
Disc	GS-C25			1.4308			1.4408			1.4408		
Stem	13Cr			1.4308			1.4408			1.4408		
Disc Sealing Face	13Cr	13Cr	STL	1.4308	STL	1.4408	STL	1.4408	STL	1.4408	STL	1.4408
Seat Ring Sealing Face	13Cr	STL	STL	1.4308	STL	1.4408	STL	1.4408	STL	1.4408	STL	1.4408

Main part material of Stainless steel

Body	1.4308			1.4408			1.4306			1.4301		
Disc	1.4308			1.4408			1.4306			1.4301		
Stem	F304			1.4408			1.4306			1.4301		
Wedge Disc Sealing Face	1.4308	1.4308	STL	1.4408	1.4408	STL	1.4306	1.4306	STL	1.4301	1.4301	STL
Ring Sealing Face	1.4308	STL	STL	1.4408	STL	STL	1.4306	STL	STL	1.4301	STL	STL

DIN Globe Valve

GENERAL VALVE

Size main dimensions of Globe Valve

Pressure (MPa)		PN1.6MPa															
Size	mm	15	20	25	32	40	50	65	80	100	125	150	200	250	300	350	400
L		130	150	160	180	200	230	290	310	350	400	480	600	650	750	850	950
H		240	260	276	285	300	305	354	402	437	496	541	699	815	914	1189	1350
W		120	140	160	160	180	200	200	750	250	300	350	400	450	500	550	600
Weight(kg)		5.2	7.1	7.4	8.5	13	20	25	35	50	75	100	210	446	648	805	1050

Pressure (MPa)		PN2.5MPa															
Size	mm	15	20	25	32	40	50	65	80	100	125	150	200	250	300	350	400
L		130	150	160	180	200	230	290	310	350	400	480	600	650	750	850	950
H		240	260	276	285	300	325	363	415	453	505	556	744	864	948	1269	1450
W		120	140	160	160	180	200	200	250	300	350	400	450	500	550	600	600
Weight(kg)		6	7.5	8	9	14	22	27	38	55	82	105	220	450	660	810	1100

Pressure (MPa)		PN4.0MPa															
Size	mm	15	20	25	32	40	50	65	80	100	125	150	200	250	300	350	400
L		130	150	160	180	200	230	290	310	350	400	480	600	650	750	850	950
H		240	260	276	285	300	325	370	430	480	532	589	783	888	965	1285	1512
W		120	140	160	160	180	200	200	250	300	350	400	450	500	550	600	600
Weight(kg)		6	7.5	8	9	15	24	30	41	60	85	110	225	460	670	830	1120

Pressure (MPa)		PN6.4MPa											
Size	mm	40	50	65	80	100	125	150	200	250	300	350	400
L		260	300	340	380	430	500	550	650	775	900	1025	1150
H		300	305	354	402	437	496	541	699	815	914	1189	1350
W		180	200	200	750	250	300	350	400	450	500	550	600
Weight(kg)		17	26	33	45	65	90	120	230	470	680	850	1130

Pressure (MPa)		PN10.0MPa											
Size	mm	40	50	65	80	100	125	150	200	250	300	350	400
L		260	300	340	380	450	500	550	650	775	900	1025	1150
H		300	325	363	415	453	505	556	744	864	948	1269	1450
W		180	200	200	250	300	350	400	450	500	550	600	600
Weight(kg)		19	27	34	46	67	95	125	235	480	690	860	1150

DIN Check Valve General Valve



Product structural features

Check valve seal acc. to DIN is applicable to the cutting and connection of pipelines medium that are used in various industries such as petroleum, chemical industry, pharmacy, chemical fertilizer, electric power industry, etc under nominal pressure of PN1.6~16MPa, and working temperature within -110~600°C

Main structural features

1. This product has logical structure, reliable seal, excellent performance and nice design.
2. The seal surface is build-up welding with Co hard alloy, which is attrition-resistant, corrosion-resistant, has good friction resistant and long life.
3. The part material, flange and butt weld end dimension may be selected according to current operating condition and users' requirement, so that meeting the requirements of various engineering.

Technical specification

Structural Formation: BB-BG-OS & Y
 Driving Manner: Hand-Operated
 Driving Manner: Electric-Actuated
 Design Standard: DIN3356
 Face to Face: DIN3202
 Flange Ends: DIN2543-2545
 Test & Inspection: DIN3230

Notes: The size of serial, valve connecting flange can be design according to customers' requirement

Products performance specification

Nominal Pressure (MPa)	Shell Test (MPa)	Sealing Test (MPa)	Suitable Temp (°C)	Suitable Medium
1.6	2.4	1.76	-110~600°C	Water Oil & Gas
2.5	3.75	2.75		
4.0	6.0	4.4		
6.4	9.6	7.04		

Technical specification

- Structural Formation: BB-BG-OS & Y
- Driving Manner: Wc-Co Hand-Operated
- Driving Manner: Electric-Actuated
- Design Standard: DIN3356
- Face to Face: DIN3202
- Flange Ends: DIN2543-2547
- Test & Inspection: DIN3230

○ Notes: The size of serial, valve connecting flange can be design according to customers' requirement.

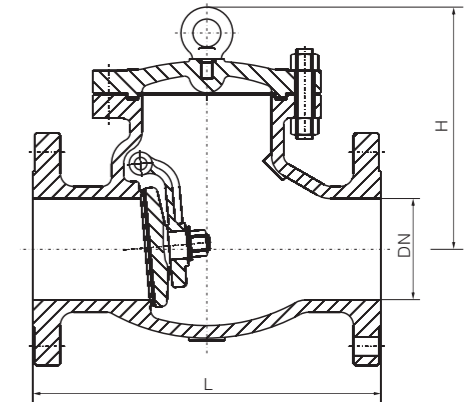

Main part material of Cast steel

Body	GS-C25						
Cover	GS-C25		1.4308		1.4408		
Disc Sealing Face	13Cr	13Cr	STL	1.4308	STL	1.4408	STL
Seat Ring Sealing Face	13Cr	STL	STL	1.4308	STL	1.4408	STL

Main part material of Stainless steel

Body	1.4308	1.4408	1.4306			1.4301						
Cover	1.4308		1.4408		1.4306			1.4301				
Wedge Disc Sealing Face	1.4308	1.4308	STL	1.4408	1.4408	STL	1.4306	1.4306	STL	1.4301	1.4301	STL
Seat Ring Sealing Face	1.4308	STL	STL	1.4408	STL	STL	1.4306	STL	STL	1.4301	STL	STL

DIN Swing Check Valve

GENERAL VALVE

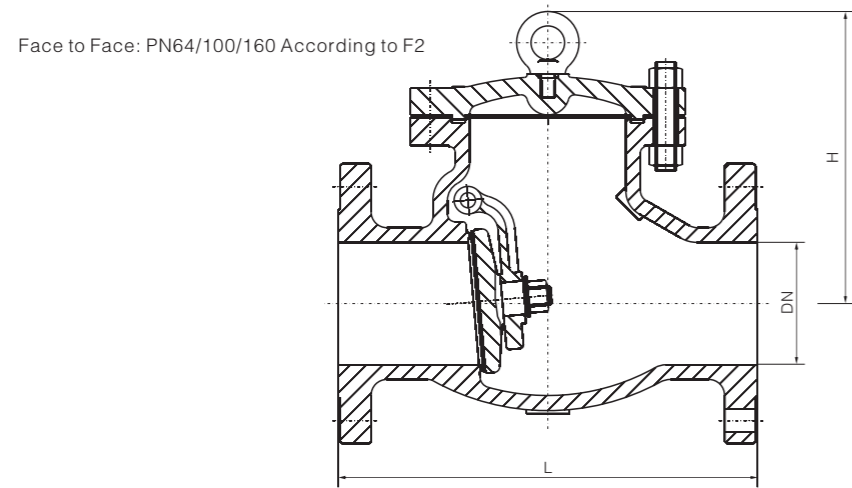

Size main dimensions of Swing Check Valve

Pressure (MPa)		PN1.6MPa											
Size	mm	50	65	80	100	125	150	200	250	300	350	400	
L		230	290	310	350	400	480	550	650	750	850	950	
H		305	354	402	437	496	541	699	815	914	1189	1350	
Weight(kg)		21	28	38	58	92	130	210	295	365	410	460	
Pressure (MPa)		PN2.5MPa											
Size	mm	50	65	80	100	125	150	200	250	300	350	400	
L		230	290	310	350	400	480	550	650	750	850	950	
H		325	363	415	453	505	556	744	864	948	1269	1450	
Weight(kg)		22	29	38	61	96	132	213	297	375	415	480	
Pressure (MPa)		PN4.0MPa											
Size	mm	50	65	80	100	125	150	200	250	300	350	400	
L		230	290	310	350	400	480	550	650	750	850	950	
H		325	370	430	480	532	589	783	888	965	1285	1512	
Weight(kg)		22	31	41.5	65	100	136	220	305	400	450	510	
Pressure (MPa)		PN6.4MPa											
Size	mm	50	65	80	100	125	150	200	250	300	350	400	
L		300	340	380	430	500	550	650	775	900	1025	1150	
H		305	354	402	437	496	541	699	815	914	1189	1350	
Weight(kg)		27	37	57	87	135	184	266	396	643	815	1230	
Pressure (MPa)		PN10.0MPa											
Size	mm	50	65	80	100	125	150	200	250	300	350	400	
L		300	340	380	430	500	550	650	775	900	1025	1150	
H		325	363	415	453	505	556	744	864	948	1269	1450	
Weight(kg)		30	40	60	92	140	195	280	406	670	850	1260	

DIN Lift Check Valve

GENERAL VALVE

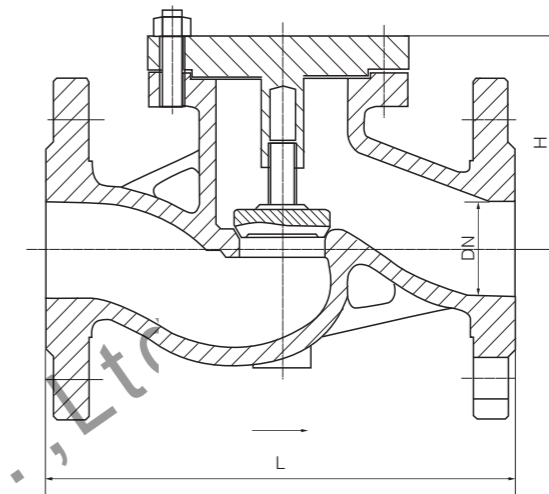

Face to Face: PN16/25/40 DN≤200 According to F1
DN≥250 According to F7

Size main dimensions of Lift Check Valve

Pressure (MPa)		PN1.6MPa											
Size	mm	50	65	80	100	125	150	200	250	300	350	400	
L		230	290	310	350	400	480	600	650	750	850	950	
H		305	354	402	437	496	541	699	815	914	1189	1350	
Weight(kg)		10	20	30	39	50	70	161	251	395	500	618	
Pressure (MPa)		PN2.5MPa											
Size	mm	50	65	80	100	125	150	200	250	300	350	400	
L		230	290	310	350	400	480	600	650	750	850	950	
H		325	363	415	453	505	556	744	864	948	1269	1450	
Weight(kg)		12	22	33	44	55	78	180	270	410	520	650	
Pressure (MPa)		PN4.0MPa											
Size	mm	50	65	80	100	125	150	200	250	300	350	400	
L		230	290	310	350	400	480	600	650	750	850	950	
H		325	370	430	480	532	589	783	888	965	1285	1512	
Weight(kg)		13	23	34	46	60	85	190	280	430	550	680	

DIN Ball Valve

GENERAL VALVE

DIN Ball Valve General Valve



Product structural features

Ball valve seal acc. to DIN is applicable to the cutting and connection of pipelines medium that are used in various industries such as petroleum, chemical industry, pharmacy, chemical fertilizer, electric power industry etc under nominal pressure of PN1.6~10MPa and working temperature within -196~150°C.

Main structural features

1. The product has indication of open-close and locking system;
2. The stem has function of anti-blow out, anti fire-safe and anti-static function;
3. The part material flange, and butting weld end dimension may be selected according to current operation condition and user's requirement, so that meeting the requirement of various engineering.

Technical specification

Structural Formation: BB-BG-OS & Y
 Driving Manner: Hand-Operated
 Driving Manner: Electric-Actuated
 Design Standard: DIN3356
 Face to Face: DIN3202
 Flange Ends: DIN2543-2545
 Test & Inspection: DIN3230

Notes: The size of serial, valve connecting flange can be design according to customers' requirement.

Products performance specification

Nominal Pressure (MPa)	Shell Test (MPa)	Sealing Test (MPa)	Suitable Temp (°C)	Suitable Medium
1.6	2.4	1.76	-196~150°C	Water Oil & Gas
2.5	3.75	2.75		
4.0	6.0	4.4		
6.4	9.6	7.04		
10.0	10.5	11		

DIN Floating Ball Valve

GENERAL VALVE

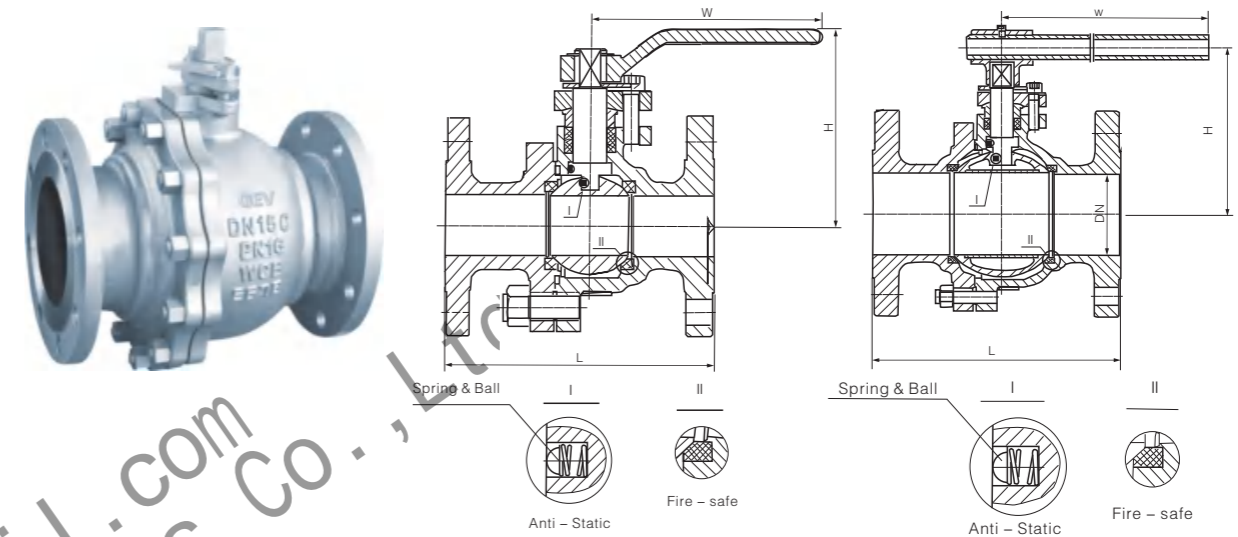

Size main dimensions of Floating Ball Valve

PN 16												
DN	15	20	25	32	40	50	65	80	100	125	150	200
L	130	140	150	165	180	200	220	250	280	320	360	400
H	78	84	95	150	150	190	195	215	250	285	330	370
H1	140	160	180	250	300	350	350	400	600	600	800	1000
Wt(Kg)	3	4	5	10	14	20	25	30	40	65	73	85
PN 25												
DN	15	20	25	32	40	50	65	80	100	125	150	200
L	130	140	150	165	180	200	220	250	280	320	360	400
H	78	84	95	150	150	190	195	215	250	285	330	370
H1	140	160	180	250	300	350	350	400	600	600	800	1000
Wt(Kg)	3	4	5	10	14	20	25	30	40	65	73	85
PN 40												
DN	15	20	25	32	40	50	65	80	100	125	150	200
L	130	140	150	165	180	200	220	250	280	403	403	502
H	82	100	104	150	150	190	195	215	250	260	275	335
H1	140	160	180	250	300	350	350	400	600	600	800	800
Wt(Kg)	3	4	5	10	14	20	25	50	70	80	85	101

DIN Trunnion Ball Valve

GENERAL VALVE

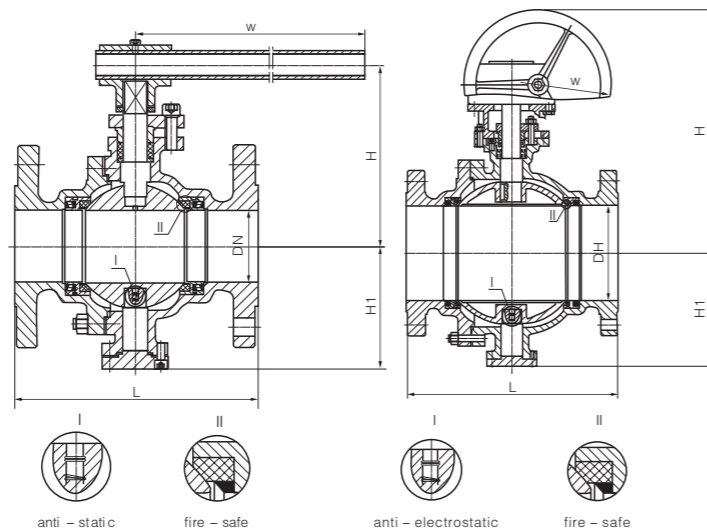

API SERIES

DIN SERIES

JIS SERIES

Size main dimensions of Trunnion Ball Valve

PN 16/25

DN	50	65	80	100	125	150	200	250	300	350	400	450	500	600	700	800	900	1000	
L	RF	179	191	203	229	356	394	457	533	610	686	762	846	914	1067	1245	1372	1524	1753
	BW	216	241	283	305	381	457	521	559	635	762	838	914	991	1143	1346	1524	1727	1880
H	107	125	152	178	300	330	398	495	580	625	670	698	840	1050	1100	1150	1247	1374	
H1	102	114	127	152	184	219	273	360	395	430	470	550	580	700	800	950	1100	1200	
W	230	400	400	650	1050	105	600	600	800	800	800	800	800	800	800	800	800	800	
Wt(Kg)	12	16	22	35	58	74	205	322	460	576	864	1280	1600	3540	4500	5940	7540	9320	

PN 40

DN	50	65	80	100	125	150	200	250	300	350	400	450	500	600	700	800	900	1000	
L	RF	216	241	283	305	381	403	502	568	648	762	838	914	991	1143	1346	1524	1727	1880
	BW	216	241	283	305	381	457	521	559	635	762	838	914	991	1143	1346	1524	1727	1880
H	107	125	152	178	300	330	398	495	580	625	670	698	840	1050	1100	1150	1247	1374	
H1	102	114	127	152	184	219	273	360	395	430	470	550	580	700	800	950	1100	1200	
W	230	400	400	650	1050	1050	600	600	800	800	800	800	800	800	800	800	800	800	
Wt(Kg)	15	24	30	55	87	118	255	370	533	640	1080	1542	2100	4200	5300	7860	8684	10300	

PN 64

DN	50	65	80	100	150	200	250	300	350	400	500	600	700						
L	RF	292	330	356	406	495	597	673	762	826	902	1054	1282	1397					
	BW	292	330	356	406	495	597	673	762	826	902	1054	1282	1397					
H	108	155	197	235	300	374	445	512	550	615	810	1010	1180						
H1	114	124	133	159	250	294	395	445	500	530	660	800	900						
W	600	600	600	600	600	800	800	800	800	800	800	800	800						
Wt(Kg)	23	35	49	91	192	355	640	880	1100	1540	2800	5300	5700						

PN 100

DN	50	65	80	100	150	200	250	300	350	400	500	600	700						
L	RF	292	330	356	432	559	660	787	838	889	991	1194	1397	1579					
	BW	292	330	356	432	559	660	787	838	889	991	1194	1397	1579					
H	108	155	197	235	300	374	445	512	550	615	810	1010	1180						
H1	114	124	133	159	250	294	395	445	500	530	660	800	900						
W	600	600	600	600	600	800	800	800	800	800	800	800	800						
Wt(Kg)	23	38	55	102	232	290	710	960	1700	1970	3250	5800	6700						

info@shen324.com
 Super Range Pipe Fittings Co., Ltd